

RECOMMENDED DIMENSIONS
FOR PC-BOARD PAD

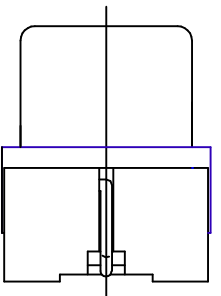

REV.	DESCRIPTION/ECO NO.	DATE
A	RELEASED	5/13/02
B	CHANGE BASE DESIGN	6/7/02
	DIMENSION CHANGES	6/26/02

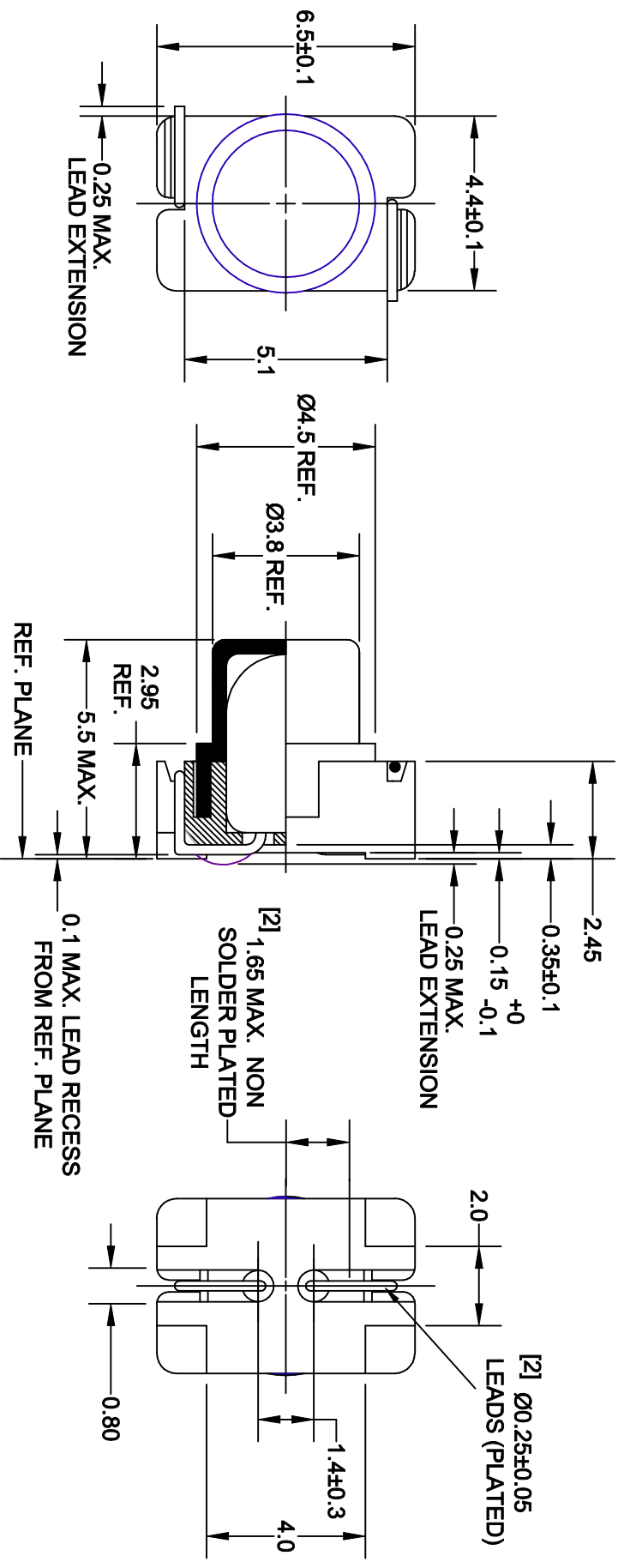

LAMP NUMBER: 7152				
VOLTS RATED	AMPS ± 10%	*MSCP ± 25%	*LUMENS ± 25%	AVERAGE LIFE HRS. 20,000**
5.0	.115	.150	1.89	C-2R

*LAMP RATING ONLY WITHOUT BASE AND FILTER

FILTER NUMBER: 39-26-3A
COLOR REF.: YELLOW

**DERIVED FROM ACCELERATED TESTING

JKL PART NUMBER: CSD4-7152/39-26-3A

				JKL COMPONENTS CORPORATION	
METRIC DIMENSIONS ARE IN MILLIMETERS TOLERANCE UNLESS OTHERWISE SPECIFIED 1 PL +/- 0.2 2 PL +/- 0.20 ANGLE +/- 0		JKL		T-1 SURFACE MOUNT LAMP WITH BASE AND FILTER (LOW PROFILE)	
DRAWN BY L. WENGSTROM	APP'D BY J.K.	DATE 6/26/02	SIZE A	FSCM NO. 55335	DRAWING NO. CSD4-7152/39-26-3A
- CAD DRAWING - MANUAL REVISIONS NOT PERMITTED			SCALE NONE	RELEASED DATE 5/13/02	REVISION DATE 6/26/02
				SHEET 1 OF 1	REV. B