

ASSEMBLY PART NUMBER	COLOR	KEYING OPTION	CPA	CLIPSLOT	TOOLED	STATUS SEE NOTE 8
34062-0001	BLACK	A	NO	NO	YES	OBsolete
34062-0002	GRAY	B	NO	NO	YES	OBsolete
34062-0003	BLACK	C	NO	NO	YES	OBsolete
34062-0004	BLACK	D	NO	NO	YES	OBsolete
34062-0005	BLACK	A	YES	NO	YES	OBsolete
34062-0006	GRAY	B	YES	NO	YES	PLANNED FOR OBSOLESCENCE SEE REFERENCE P/N 34062-0026
34062-0007	BLACK	C	YES	NO	YES	OBsolete
34062-0008	BLACK	D	YES	NO	YES	OBsolete
34062-0009	GRAY	D	NO	NO	YES	OBsolete
34062-0010	GRAY	D	YES	NO	YES	OBsolete
34062-0011	BLACK	A	NO	YES	YES	OBsolete
34062-0012	GRAY	B	NO	YES	NO	OBsolete
34062-0013	BLACK	C	NO	YES	NO	OBsolete
34062-0014	BLACK	D	NO	YES	NO	OBsolete
34062-0015	BLACK	A	YES	YES	YES	OBsolete
34062-0016	GRAY	B	YES	YES	NO	OBsolete
34062-0017	BLACK	C	YES	YES	NO	OBsolete
34062-0018	BLACK	D	YES	YES	NO	OBsolete
34062-0019	GRAY	D	NO	YES	NO	OBsolete
34062-0020	GRAY	D	YES	YES	NO	OBsolete

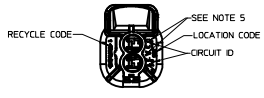
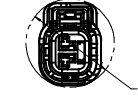
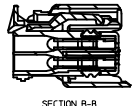
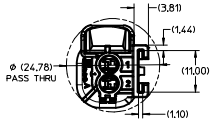
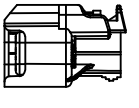
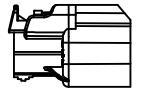
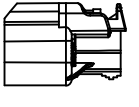
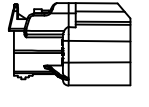
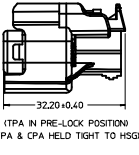
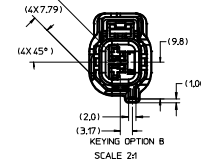
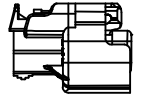
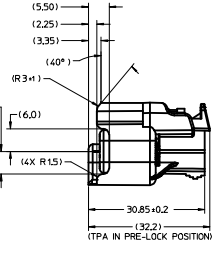
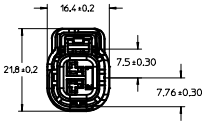
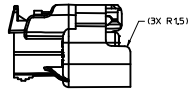
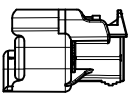
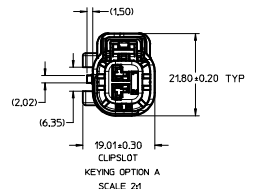
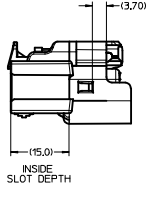
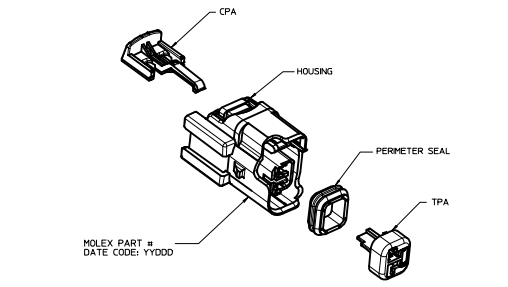
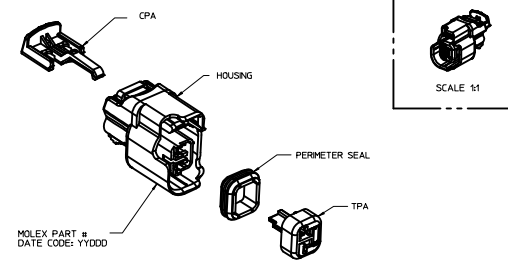
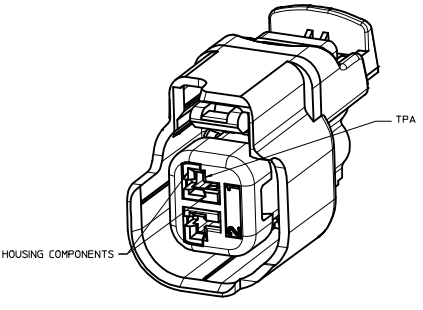
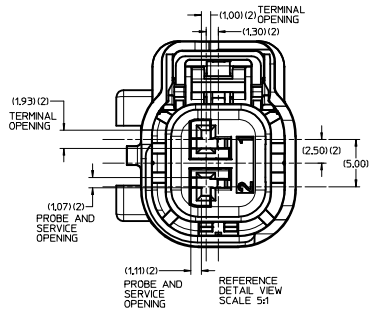

- NOTES: UNLESS OTHERWISE SPECIFIED
- ASSEMBLY CONFORMS TO: SAE/JSCAR-12, REV 2; SAE/JSCAR-2 REV 4; EXCEPT TPA REMOVAL FROM FINAL LOCK - SECOND CYCLE. SHALL NOT BE LESS THAN 12 NEWTONS.
  - DESIGNED TO MATE WITH DEVICE CONNECTION AS SPECIFIED IN EWCAP DRAWING 150-5-002-1-201 REV A (9-18-2003).
  - ASSEMBLY SHIPPED WITH TPA IN PRE-LOCK POSITION (SEE SECTION B-B PRE-LOCK). UPON FULL TERMINAL ASSEMBLY, EACH TPA MUST BE SNAPPED INTO ITS FINAL-LOCK POSITION.
  - OPTIONAL CPA SHOWN IN ALL VIEWS. SEE TABLES FOR SPECIFIC ASSEMBLY OPTION AND NUMBER.
  - KEYING OPTION AND ASSEMBLY MACHINE IDENTIFIER.
  - RECYCLE CODE FOR PERMETER SEAL: SILICON 50 DROMETER HOUSING: PPE/PA-GF10 TPA/CPA: PFT-GF30
  - SYSTEM TESTED USING E58-ML123-A, 16,18,20&22 AWG WIRE, MS-8288 AND MS9502 ARE ACCEPTABLE ALTERNATIVES.
  - FOR RECOMMENDED PART NUMBERS NOT SHOWN ON THIS DRAWING SEE SD-34062-002 & SD-34062-004.

QTY	DESCRIPTION	REF	QTY	DESCRIPTION	REF	QTY	DESCRIPTION	REF	QTY	DESCRIPTION	REF	QTY	DESCRIPTION	REF	QTY	DESCRIPTION	REF	QTY	DESCRIPTION	REF		
22	0.50	34083-2003	34083-0003	RIGHT	TIN	22	7158-3030-50	120-170	RED	E-1644-01	119-165											
22	0.50	34083-3003	34083-1003	LEFT	TIN	22	7158-3030-50	120-170	RED	E-1644-01	119-165											
22	0.50	34081-2005	34081-0005	RIGHT	GOLD	22	7158-3030-50	120-170	RED	E-1644-01	119-165											
22	0.50	34081-3005	34081-1005	LEFT	GOLD	22	7158-3030-50	120-170	RED	E-1644-01	119-165											
20	0.75	34083-2002	34083-0002	RIGHT	TIN	18/20	7158-3031-90	163-240	BLUE	E-1644-00	160-210											
20	0.75	34083-3002	34083-1002	LEFT	TIN	18/20	7158-3031-90	163-240	BLUE	E-1644-00	160-210											
20	0.75	34081-2004	34081-0004	RIGHT	GOLD	18/20	7158-3031-90	163-240	BLUE	E-1644-00	160-210											
20	0.75	34081-3004	34081-1004	LEFT	GOLD	18/20	7158-3031-90	163-240	BLUE	E-1644-00	160-210											
18	1.0	34083-2002	34083-0002	RIGHT	TIN	18/20	7158-3031-90	163-240	BLUE	E-1644-00	160-210											
18	1.0	34083-3002	34083-1002	LEFT	TIN	18/20	7158-3031-90	163-240	BLUE	E-1644-00	160-210											
18	1.0	34081-2004	34081-0004	RIGHT	GOLD	18/20	7158-3031-90	163-240	BLUE	E-1644-00	160-210											
18	1.0	34081-3004	34081-1004	LEFT	GOLD	18/20	7158-3031-90	163-240	BLUE	E-1644-00	160-210											
16	1.5	34083-3001	34083-0001	RIGHT	TIN	14/16	7158-3031-90	163-240	BLUE	E-1644-02	210-250											
16	1.5	34083-3001	34083-0001	LEFT	TIN	14/16	7158-3031-90	163-240	BLUE	E-1644-02	210-250											
16	1.5	34081-2003	34081-0003	RIGHT	GOLD	16	7158-3031-90	163-240	BLUE	E-1644-02	210-250											
16	1.5	34081-3003	34081-1003	LEFT	GOLD	16	7158-3031-90	163-240	BLUE	E-1644-02	210-250											
AWG	METRIC						YAZAKI P/N	WIRE OD RANGE	COLOR	OSR P/N	WIRE OD RANGE	COLOR										

<b>ENTER DESCRIPTION</b> EC NO: UAU2016-1545 DRAWING: 2016/03/06 DATE: 2016/06/28 REVISION: 1	<b>QUALITY SYMBOLS</b> 	<b>GENERAL TOLERANCES (UNLESS SPECIFIED)</b> mm INCH 4 PLACES ± --- ± --- 3 PLACES ± --- ± --- 2 PLACES ± 0.10 ± --- 1 PLACE ± 0.3 ± --- 0 PLACE ± ± ---	<b>DIMENSION STYLE</b> MM ONLY DRAWN BY DATE L.P.LIM 2002/11/15 CHECKED BY DATE DKOEHLER 2002/11/25 APPROVED BY DATE CPENDLET 2002/11/25	<b>SCALE</b> 2:1 <b>DESIGN UNITS</b> METRIC <b>THIRD ANGLE PROJECTION</b>	<b>TITLE</b> CONNECTOR ASSEMBLY 2-WAY FUEL 15MM FEMALE FUEL INJECTOR CONNECTOR <b>molex</b>	<b>MATERIAL NO.</b> SD-34062-001 <b>DOCUMENT NO.</b> SD-34062-001 <b>SHEET NO.</b> 1 OF 1
	<b>DRAFT WHERE APPLICABLE MUST REMAIN WITHIN DIMENSIONS</b>					
	<b>THIS DRAWING CONTAINS INFORMATION THAT IS PROPRIETARY TO MOLEX INCORPORATED AND SHOULD NOT BE USED WITHOUT WRITTEN PERMISSION</b>					
	<b>INCORPORATED AND SHOULD NOT BE USED WITHOUT WRITTEN PERMISSION</b>					

TABLE OF CONTENTS	
SHEET NO.	SHEET DESCRIPTION
1	NOTES
2, 3	CONFIGURATIONS
4	RECEPTACLE CONNECTOR ASSEMBLY
5	MOLEX INTERFACE

NOTES: VALID UNLESS OTHERWISE SPECIFIED

1. GENERAL:
- a. APPLICATION SPECIFICATION SEE: AS-34062-000
    - CONTAINS: PRODUCT INTRODUCTION, PRODUCT SUMMARY, CONNECTOR ASSEMBLY, PACKAGING INFORMATION, CONNECTOR MATING, SERVICE INSTRUCTIONS, ELECTRICAL CONTINUITY CHECKING, CRIMPING, AND TROUBLESHOOTING.
    - DESIGNED TO MATE WITH DEVICE CONNECTION AS SPECIFIED IN DRAWING EWCAP 150-S-002-1-Z01, AVAILABLE AT <http://ewcap.uscar1teams.org/>.
    - DESIGNED TO MATE WITH BLADE SEALED ASSEMBLY AS SPECIFIED IN DRAWING: SD-34675-001
    - ASSEMBLY SHIPPED WITH TPA IN PRE-LOCK (SEE TPA PRE-LOCK VIEW IN SHEET 4)
  - b. PRODUCT SPECIFICATION SEE: PS-34062-000
    - CONTAINS: SCOPE, PRODUCT DESCRIPTION, INTEGRAL COMPONENTS AND ACCESSORIES, APPLICABLE DOCUMENTS AND SPECIFICATIONS, RATINGS, PERFORMANCE, PACKAGING, GAUGE AND FIXTURES, AND OTHER INFORMATION.
  - c. PACKAGING SPECIFICATION PER MOLEX DRAWING: PK-30907-879
  - d. PARTS MUST BE IN COMPLIANCE TO MOLEX CHEMICAL SUBSTANCES FOR PRODUCTS AND PACKAGING SPECIFICATION: OEHS-699000-301
  - e. DATA MUST BE SUBMITTED UNDER THE MOLEX PART NUMBER TO IMDS (COMPANY ID#13255)
2. DESIGN - MATERIALS:
- a. SEE BOM TABLE IN SD-34062-004
3. DESIGN - GEOMETRY:
- a. THIS IS A 100% CAD GENERATED PART. THE CAD MATHEMATICAL DATA IS THE MASTER FOR THIS PART. FOR DIMENSIONAL OR ANY INFORMATION NOT SHOWN ON THIS DRAWING, ANALYZE THE CAD MODEL.
  - b. GEOMETRIC DIMENSIONS AND TOLERANCES PER ASME Y14.5M - 1994
  - c. EDGES AND UNDIMENSIONED DETAILS PER ISO13715
  - d. CORNERS SHOWN AS SHARP TO BE R 0.2 MAX.
  - e. LETTERING SHALL BE 0.15 MAX RAISED IN 0.25 MAX RECESS PAD. THIS INCLUDES RECYCLING CODE, CAVITY ID, VENDOR IDENTIFICATION, AND CUSTOMER MATERIAL NUMBER.
  - f. VISUAL DEFECTS SHALL MEET COSMETIC STANDARD PS-45499-002 (Class B)
  - g. LASER MARKING: TBD

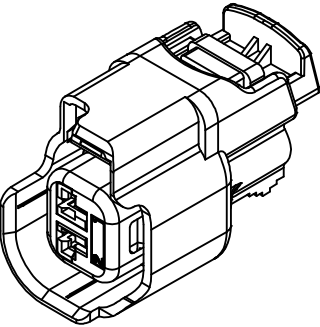
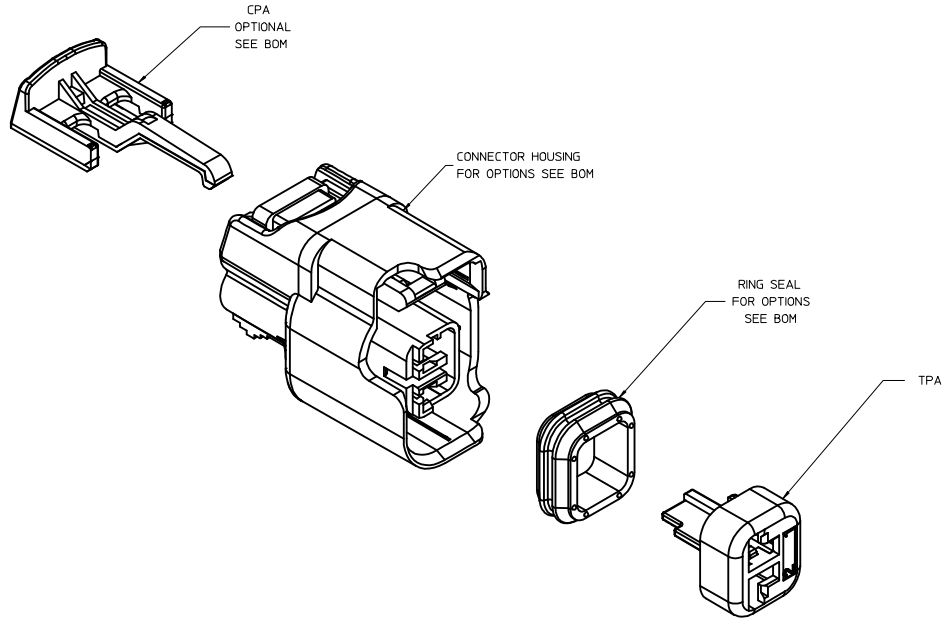

REV	DESCRIPTION
J18	ADDED DIM ICD 64

INSPECTION NUMBER LOG  
 LAST NUMBER USED: ICD 64  
 ADDED: ICD 64  
 REMOVED: ICD 7, ICD 8, ICD 9,  
 ICD 18, ICD 19, ICD 20, ICD 41, ICD 42

<b>ENTER DESCRIPTION</b> IEC NO. UAU2016-1241 DRAWN BY BOURZENSKI, 2016/02/19 CHKD: APPR: VKOSHY 2016/02/22	<b>QUALITY SYMBOLS</b> ▽=0 ▽=0 ▽=0	<b>GENERAL TOLERANCES (UNLESS SPECIFIED)</b> <table border="1"> <tr> <td></td> <td>mm</td> <td>INCH</td> </tr> <tr> <td>4 PLACES</td> <td>± 0.3</td> <td>± 0.012</td> </tr> <tr> <td>3 PLACES</td> <td>± 0.2</td> <td>± 0.010</td> </tr> <tr> <td>2 PLACES</td> <td>± 0.10</td> <td>± 0.004</td> </tr> <tr> <td>1 PLACE</td> <td>± 0.3</td> <td>± 0.012</td> </tr> <tr> <td>0 PLACE</td> <td>±</td> <td>±</td> </tr> </table> ANGULAR ± 3 ° DRAFT WHERE APPLICABLE MUST REMAIN WITHIN DIMENSIONS		mm	INCH	4 PLACES	± 0.3	± 0.012	3 PLACES	± 0.2	± 0.010	2 PLACES	± 0.10	± 0.004	1 PLACE	± 0.3	± 0.012	0 PLACE	±	±	<table border="1"> <tr> <td><b>DIMENSION STYLE</b></td> <td><b>SCALE</b></td> <td><b>DESIGN UNITS</b></td> <td><b>THIRD ANGLE PROJECTION</b></td> </tr> <tr> <td>MM ONLY</td> <td>4:1</td> <td>METRIC</td> <td></td> </tr> </table>	<b>DIMENSION STYLE</b>	<b>SCALE</b>	<b>DESIGN UNITS</b>	<b>THIRD ANGLE PROJECTION</b>	MM ONLY	4:1	METRIC	
		mm	INCH																										
4 PLACES	± 0.3	± 0.012																											
3 PLACES	± 0.2	± 0.010																											
2 PLACES	± 0.10	± 0.004																											
1 PLACE	± 0.3	± 0.012																											
0 PLACE	±	±																											
<b>DIMENSION STYLE</b>	<b>SCALE</b>	<b>DESIGN UNITS</b>	<b>THIRD ANGLE PROJECTION</b>																										
MM ONLY	4:1	METRIC																											
DRAWN BY DATE KCUNNINGHAM 2011/11/08 CHECKED BY DATE MVANSLAMBROU 1/26/2012 APPROVED BY DATE	MATERIAL NO. <b>SEE NOTE 2a.</b> SIZE D THIS DRAWING CONTAINS INFORMATION THAT IS PROPRIETARY TO MOLEX INCORPORATED AND SHOULD NOT BE USED WITHOUT WRITTEN PERMISSION	<b>DESCRIPTION</b> MX150 2 WAY CABLE SEAL RECEPTACLE CONN. SYSTEM (5.0MM PITCH)  DOCUMENT NO. SD-34062-002	SHEET NO. 1 OF 5																										

**SHEET DESCRIPTION**  
CONFIGURATIONS

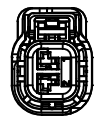
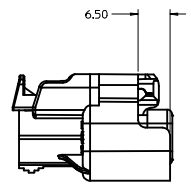

OPTION A

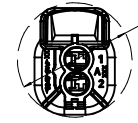
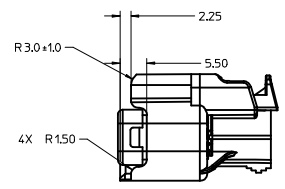

REAR VIEW

Ø23.40  
MINIMUM PASS-THRU WITH  
NO CLEARANCE  
APPLIES TO NON CLIP-SLOT  
OPTIONS A, C, D, & G

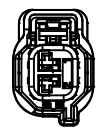
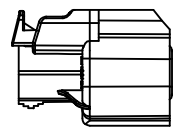

OPTION B

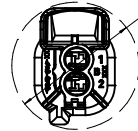
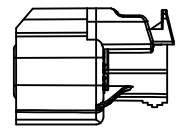

REAR VIEW

Ø26.00  
MINIMUM PASS-THRU WITH  
NO CLEARANCE  
APPLIES TO NON CLIP-SLOT  
OPTIONS B, E, & F

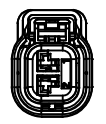
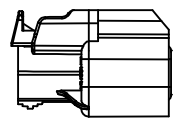

OPTION C

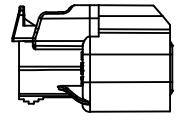
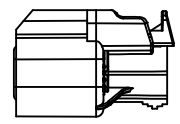

OPTION D

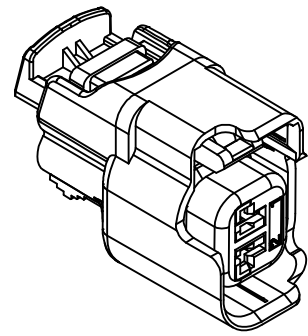
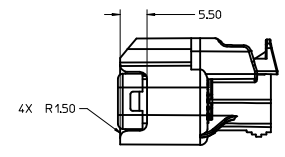

NON CLIP-SLOT OPTION  
SCALE 4:1

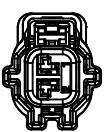
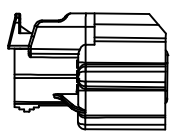

OPTION E

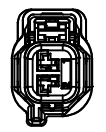
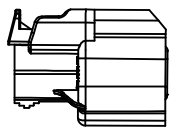
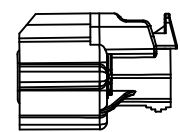

OPTION F

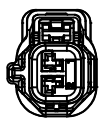
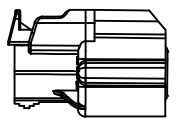
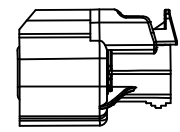

OPTION G

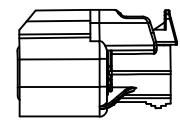

<b>ENTER DESCRIPTION</b> IEC NO. UAU2016-1241 DRAWN BY GURUSZENSKI, 2016/02/19 CHKD: CHYD: APPR: WKSHY J18	QUALITY SYMBOLS ∇=0 ∇=0 ∇=0	GENERAL TOLERANCES (UNLESS SPECIFIED) mm      INCH		DIMENSION STYLE <b>MM ONLY</b>	SCALE <b>2:1</b>	DESIGN UNITS <b>METRIC</b>	THIRD ANGLE PROJECTION
		4 PLACES ± --- ± --- 3 PLACES ± 0.10 ± --- 2 PLACES ± 0.3 ± --- 1 PLACE ± ± --- 0 PLACE ± ±	DRAWN BY DATE KCUNNINGHAM 2011/11/08 CHECKED BY DATE MYANSLAMBROU 1/26/2012 APPROVED BY DATE	MATERIAL NO. <b>SEE NOTE 2a.</b>		DOCUMENT NO. <b>SD-34062-002</b>	SHEET NO. 2 OF 5
THIS DRAWING CONTAINS INFORMATION THAT IS PROPRIETARY TO MOLEX INCORPORATED AND SHOULD NOT BE USED WITHOUT WRITTEN PERMISSION							

**SHEET DESCRIPTION**  
CONFIGURATIONS

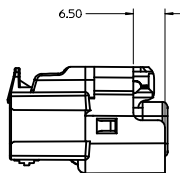

OPTION A W/CLIP-SLOT \*

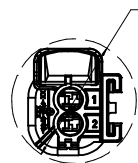
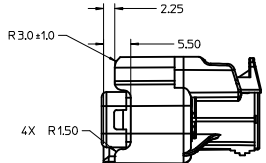

Ø 25.50  
MINIMUM PASS-THRU WITH NO CLEARANCE APPLIES TO CLIP-SLOT OPTIONS A, C AND D

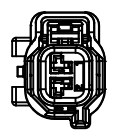
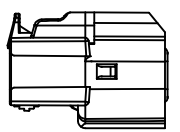

OPTION B W/CLIP-SLOT \*

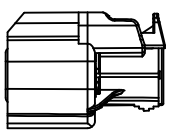

Ø 26.00  
MINIMUM PASS-THRU WITH NO CLEARANCE APPLIES TO CLIP-SLOT OPTION B

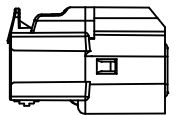

OPTION C W/CLIP-SLOT \*

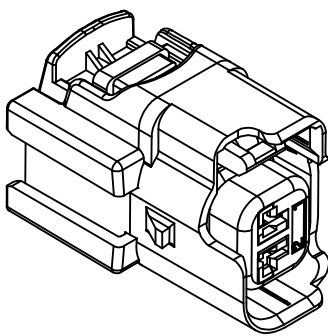
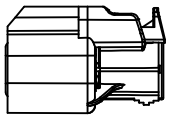

CLIP-SLOT OPTION  
SCALE 4:1

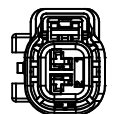
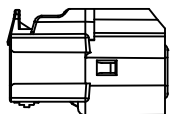

OPTION D W/CLIP-SLOT \*

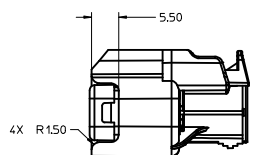

\*WITH CLIP-SLOT CONFIGURATIONS  
DO NOT MEET THE USCAR PACKAGING FRAME REQUIREMENTS

<b>ENTER DESCRIPTION</b> LEC NO: UAU2016-1241 DRAWN: BORUSZESKI, 2016/02/19 CHKD: APPR: IKOSHY 2016/02/22 <b>J18</b>	QUALITY SYMBOLS ∇=0 ∇=0 ∇=0	GENERAL TOLERANCES (UNLESS SPECIFIED) mm INCH 4 PLACES ± --- ± --- 3 PLACES ± --- ± --- 2 PLACES ± 0.10 ± --- 1 PLACE ± 0.3 ± --- 0 PLACE ± ±	DIMENSION STYLE <b>MM ONLY</b>	SCALE <b>2:1</b>	DESIGN UNITS <b>METRIC</b>	THIRD ANGLE PROJECTION
	DRAFT WHERE APPLICABLE MUST REMAIN WITHIN DIMENSIONS		MATERIAL NO. <b>SEE NOTE 2a.</b>	DOCUMENT NO. <b>SD-34062-002</b>	SHEET NO. <b>3 OF 5</b>	
	TITLE <b>MX150 2 WAY CABLE SEAL RECEPTACLE CONN. SYSTEM (5.0MM PITCH)</b>					
	THIS DRAWING CONTAINS INFORMATION THAT IS PROPRIETARY TO MOLEX INCORPORATED AND SHOULD NOT BE USED WITHOUT WRITTEN PERMISSION					

**SHEET DESCRIPTION**

RECEPTACLE CONNECTOR ASSEMBLY

**CHARTED DIMENSIONS**

CONFIGURATIONS	DIMENSIONS	
	A	B
OPTIONS A, C, D	16.6	22.0
OPTION B	16.6	23.9
OPTION E	20.2	23.9
OPTION F	16.6	23.9
OPTION G	18.4	22.0
OPTIONS A, C, D W/CLIP-SLOT	19.2	22.0
OPTION B W/CLIP-SLOT	19.2	23.9

OPTIONAL LASER MARKING SURFACE  
SEE NOTE 3g

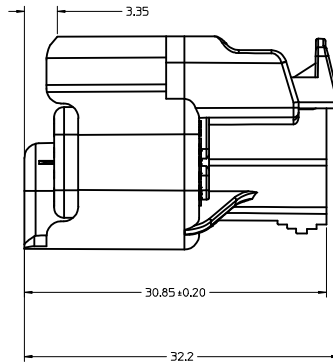
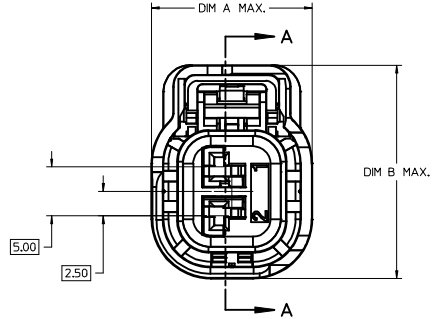
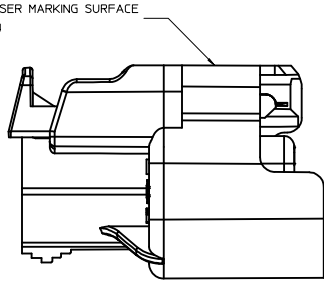

OPTIONAL LASER MARKING SURFACE  
SEE NOTE 3g

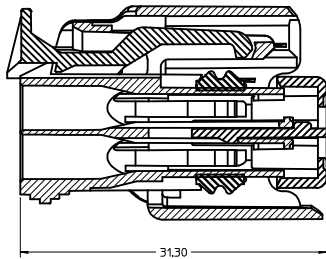
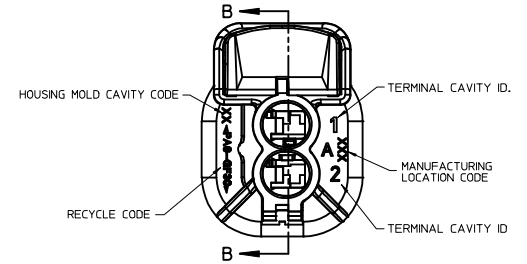
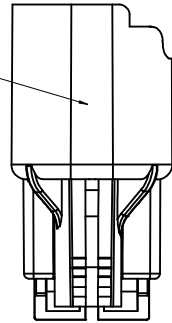

TPA SHOWN IN THE  
PRE-STAGED POSITION  
SECTION A-A

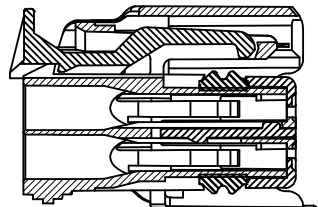

SECTION B-B  
TPA SHOWN IN  
FINAL-LOCK POSITION

<b>ENTER DESCRIPTION</b> IEC NO. UAU2016-1241 DRAWN/BORUSZENSKI, 2016/02/19 CHKD: APPR: WOSHY 2016/02/22 J18	QUALITY SYMBOLS	GENERAL TOLERANCES (UNLESS SPECIFIED)	DIMENSION STYLE	SCALE	DESIGN UNITS	THIRD ANGLE PROJECTION
	∇=0 ∇=0 ∇=0	mm INCH 4 PLACES ± --- ± --- 3 PLACES ± --- ± --- 2 PLACES ± 0.10 ± --- 1 PLACE ± 0.3 ± --- 0 PLACE ± ±	MM ONLY	4:1	METRIC	DRAWN BY DATE KCUNNINGHAM 2011/11/08 CHECKED BY DATE MYANSLAMBROU 1/26/2012 APPROVED BY DATE
	ANGULAR ± 3 ° DRAFT WHERE APPLICABLE MUST REMAIN WITHIN DIMENSIONS	MATERIAL NO. SEE NOTE 2a. SIZE D	TITLE MX150 2 WAY CABLE SEAL RECEPTACLE CONN. SYSTEM (5.0MM PITCH)	DOCUMENT NO. SD-34062-002	SHEET NO. 4 OF 5	
	THIS DRAWING CONTAINS INFORMATION THAT IS PROPRIETARY TO MOLEX INCORPORATED AND SHOULD NOT BE USED WITHOUT WRITTEN PERMISSION					

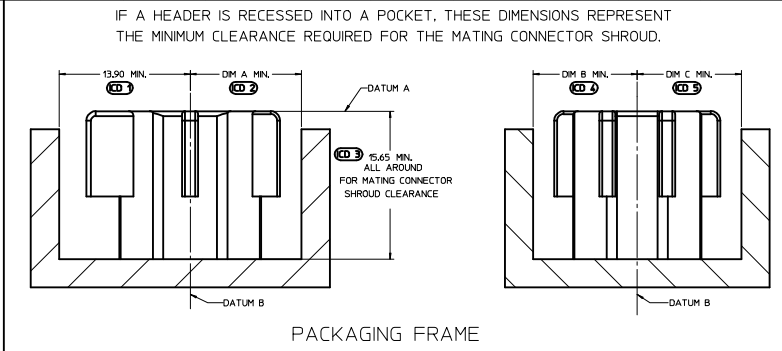
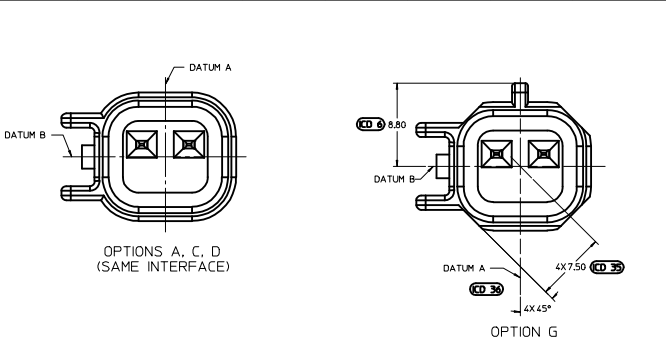

KEY OPTION	DIMENSIONS		
	DIM A	DIM B	DIM C
A, C, D	9.90	9.20	9.20
B	11.80	9.20	9.20
E	11.80	11.00	11.00
F	11.80	9.20	9.20
G	9.90	9.20	11.00
H	9.90	11.00	9.20

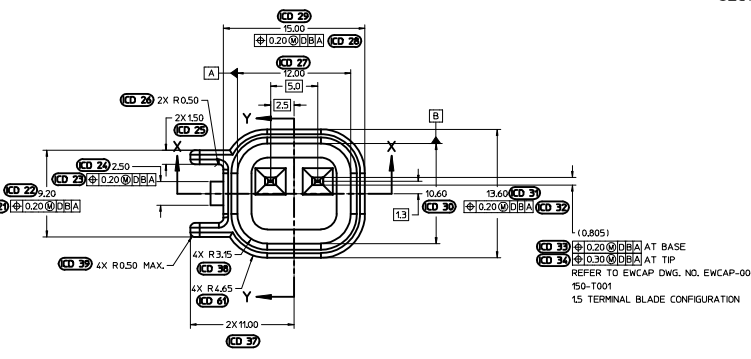
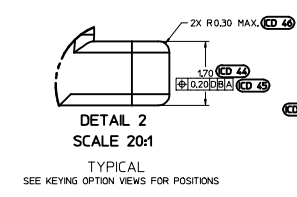
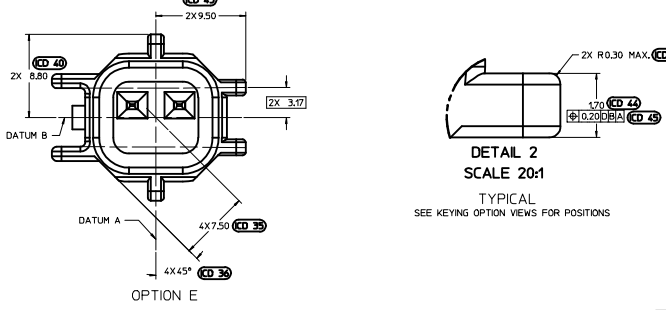
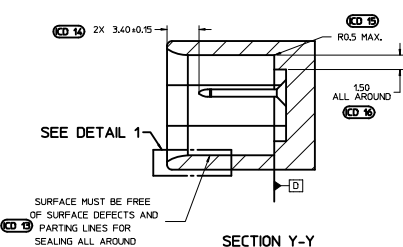
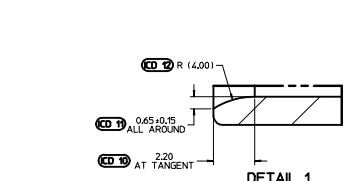
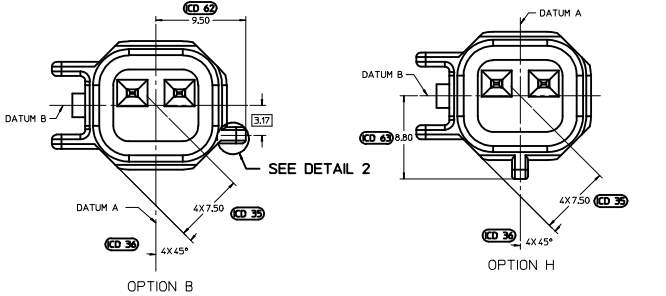
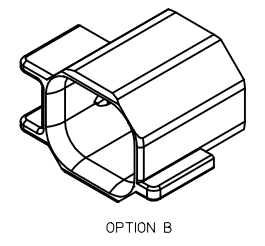

NOTES: UNLESS OTHERWISE SPECIFIED

- ALL DIMENSIONS SHOWN IN MILLIMETERS.
- DIMENSIONING AND TOLERANCING PER ASME Y14.5M-1994
- 0.25 RADI ON ALL CORNERS SHOWN SHARP.
- UNSPECIFIED RADI: 0.25 EXCEPT AS NOTED.
- STANDARD COLORS FOR POLARIZATION (SEE CHART). DEVIATION REQUIRES APPROVAL OF AUTHORIZED PERSON.
- REFER TO SAE/USCAR 12 CONNECTOR GUIDELINES FOR ADDITIONAL REQUIREMENTS.
- EXCEPT WHERE NOTED, DRAFT ON OUTSIDE SURFACES IS PERMISSIBLE WITHIN TOLERANCE.
- [Symbol] SYMBOL INDICATES DRAFT DIRECTION.
- FOR TERMINAL MATERIAL, DIMENSIONAL, AND COATING REQUIREMENTS AND ANY BLADE TERMINAL DESIGN INFORMATION NOT SHOWN ON THIS DRAWING SEE EWCAP DWG. NO. EWCAP-001
- A FULL SHROUD ON THE MATING CONNECTOR IS REQUIRED TO ENSURE THAT THE CONNECTOR-HEADER POLARIZATION FEATURES (OPTIONS A THRU H) WILL FUNCTION. THE FULL SHROUD ALSO PREVENTS SCOOP DAMAGE TO THE HEADER PINS. REFER TO SAE/USCAR-12 CONNECTOR DESIGN GUIDE LINES FOR ADDITIONAL INFORMATION.
- REFER TO USCAR/EWCAP PART LIST AS FOUND ON WEBSITE <http://www.uscarteoms.org>
- THIS IS A 100% CAD GENERATED PART. THE CAT MATHEMATICAL DATA IS THE MASTER FOR THIS PART. FOR DIMENSIONAL OR ANY INFORMATION NOT SHOWN ON THIS DRAWING, ANALYZE THE CAD MODEL.

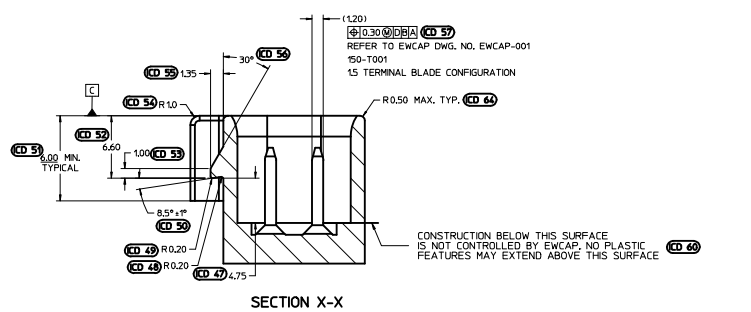
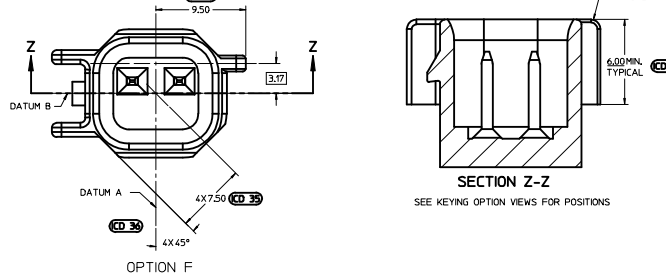

OPTION	COLOR	SIMILAR TO AFL DRAWING R63461 (OPTION GEOMETRY IDENTICAL)	COMMENTS
A, C, D	BLACK	A	
B	LIGHT GRAY	B	
E	BLACK	E	NOT RECOMMENDED MATING CONNECTOR IS UNIVERSAL.
F	LIGHT GRAY	D	
G	BLACK	C	
H	LIGHT GRAY	F	

<b>ENTER DESCRIPTION</b> EC NO. UAU2016-1241 DRAWING NO. ZENCK12016/02/15 DATE: 2016/02/12 APPR: WOSHY	QUALITY SYMBOLS	GENERAL TOLERANCES (UNLESS SPECIFIED)	DIMENSION STYLE	SCALE	DESIGN UNITS	THIRD ANGLE PROJECTION
	▽=0	mm INCH	MM ONLY	5:1	METRIC	
	▽=0	4 PLACES ± --- ± ---	KCUNNINGHAM	DATE		
	▽=0	3 PLACES ± --- ± ---	1/26/2012			
	▽=0	2 PLACES ± 0.10 ± ---				
▽=0	1 PLACE ± 0.3 ± ---					
▽=0	0 PLACE ± ±					
	ANGULAR ± 3°					
	DRAFT WHERE APPLICABLE MUST REMAIN WITHIN DIMENSIONS					

**MX150 2 WAY CABLE SEAL RECEPTACLE CONN. SYSTEM (5.0MM PITCH)**  
  
 MATERIAL NO. N/A DOCUMENT NO. SD-34062-002 SHEET NO. 5 OF 5  
 THIS DRAWING CONTAINS INFORMATION THAT IS PROPRIETARY TO MOLEX INCORPORATED AND SHOULD NOT BE USED WITHOUT WRITTEN PERMISSION