

LOC	DIST	REV	DESCRIPTION	DATE	DMN	APVD
J		A	RELEASE (ECR-05-001155)	5APR05	L.Z	I.E

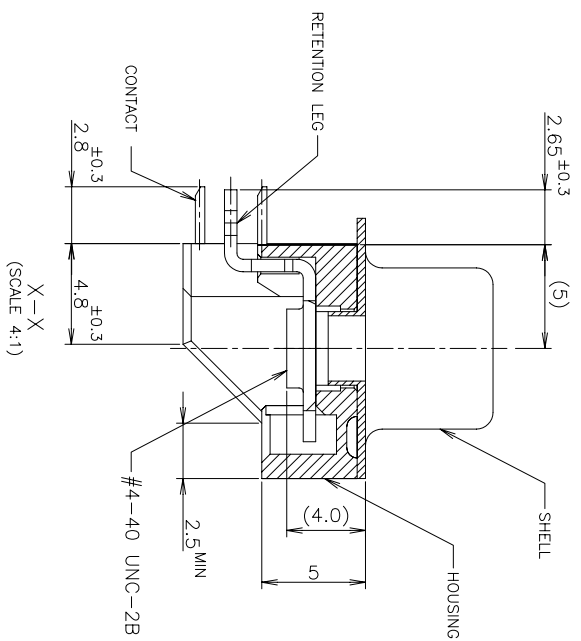
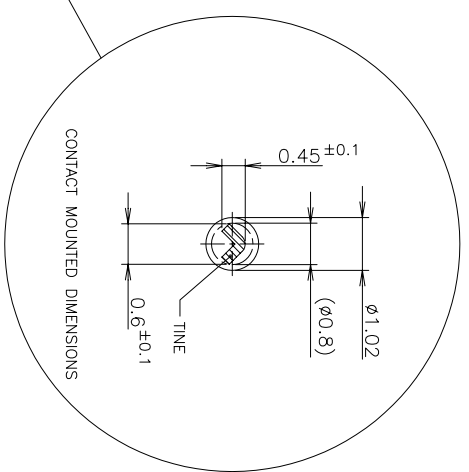
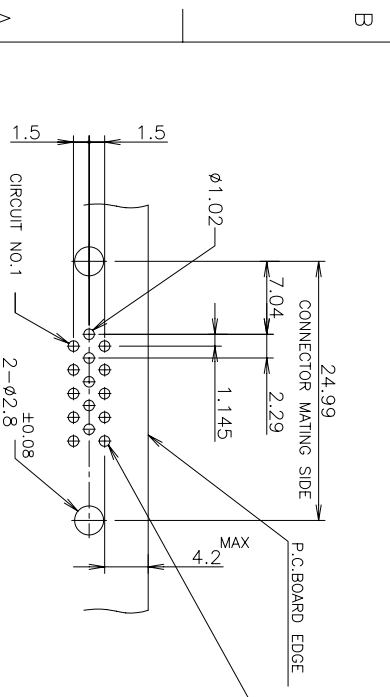
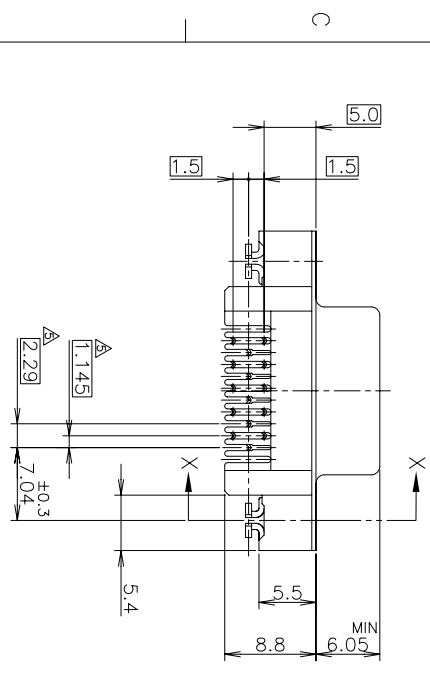
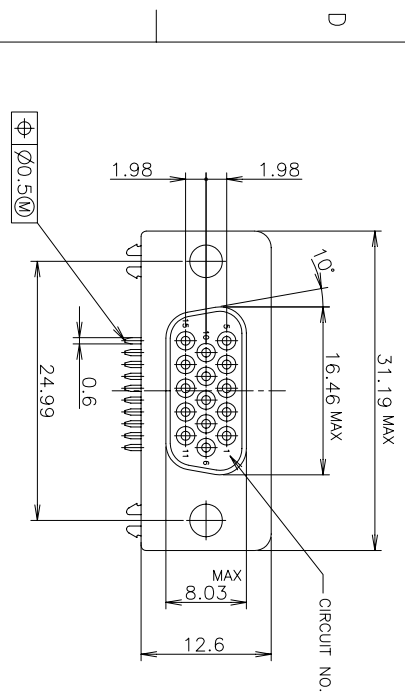

- THESE PRODUCTS CONFORM AMP SPEC. 108-5401.
- MATERIAL HOUSING: THERMOPLASTEC
SHELL: CARBON STEEL
CONTACT: COPPER ALLOY
RETENTION LEG: COPPER ALLOY
- FINISH CONTACT: GOLD PL.
SHELL: NICKEL PL.
RETENTION LEG: TIN PL.
- SCREWLOCK OR SCREW MUST BE ASSEMBLED BEFORE PLUG CONNECTOR MATING.
(SCREW ON TORQUE: 5kg-cmMAX)
P. C. BOARD MOUNTING DIMENSION CONFORM MIL SPEC. (MS-18273)

AU: 0.00076 MIN.	5179696-9
FINISH	P/N

THIS DRAWING IS A CONTROLLED DOCUMENT.	
DMN	5APR05
CHK	5APR05
APVD	5APR05
LEO ZHOU	
STEVEN YAO	
I. ENOMOTO	
PRODUCT SPEC	
APPLICATION SPEC	
WEIGHT	
CUSTOMER DRAWING	
NAME	
RECEPTACLE ASSY RIGHT ANGLE SIZE 1, 15P	
LOW PROFILE STD-D P.C.B t=0.8~1.6 DIP	
SHELL: NICKEL PL. AMPLIMITE III-J ULTRA SLIM HD-22	
SIZE	DRAWING NO
A3	00779
SCALE	5179696
SCALE	2:1
SHEET	1 OF 1
REV	A

DIMENSIONS: mm		TOLERANCES UNLESS OTHERWISE SPECIFIED:	
0 P/C	±	1 P/C	±
1 P/C	±	2 P/C	±
2 P/C	±	3 P/C	±
3 P/C	±	4 P/C	±
FINISH		ANGLES	
SEE NOTE		SEE NOTE	
MATERIAL		SEE NOTE	
GENERAL TOLERANCE		10 ≥ : ±0.2	
		30 ≥ > 10: ±0.25	
		100 ≥ > 30: ±0.3	
		ANGLES : ±3°	