

## DETAILS

<b>Product Number</b>	C11715_ANNA-40-5-W
<b>Family</b>	Anna
<b>Type</b>	Lens array
<b>Color</b>	clear
<b>Diameter</b>	40 mm
<b>Height</b>	10,7 mm
<b>Style</b>	round
<b>Optic Material</b>	PMMA
<b>Holder Material</b>	
<b>Fastening</b>	pin, glue
<b>Status</b>	production ready
<b>ROHS Compliant</b>	Yes
<b>Date Updated</b>	16/09/2014



## OPTICAL PROPERTIES

LED	Viewing	Light	Efficiency	cd/lm	Connector
	Angle	Beam			
XP-G	36 deg	Wide	87 %	2.000	-
XP-E	36 deg	Wide	87 %	1.600	-
XB-D	29 deg	Wide	85 %	2.170	-
LUXEON Rebel	30 deg	Wide	86 %	1.900	-
LUXEON Rebel ES	29 deg	Wide	86 %	2.200	-
LUXEON A	34 deg	Wide	82 %	1.680	-
NCSxx19A	28 deg	Wide	86 %	2.000	-
NVSxx19A	33 deg	Wide	86 %	1.500	-
Oslon SSL 80	26 deg	Wide	87 %	2.400	-
Oslon SSL 150	34 deg	Wide	87 %	2.400	-
Duris S5 (2 chip)	26 deg	Wide	88 %	2.900	-

D

C

B

A

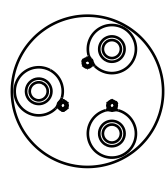

Anna-3

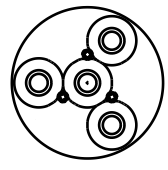

Anna-4

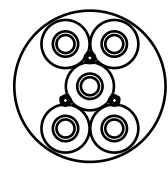

Anna-5

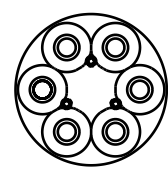

Anna-6

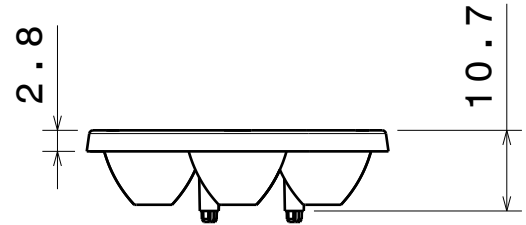

Anna-7

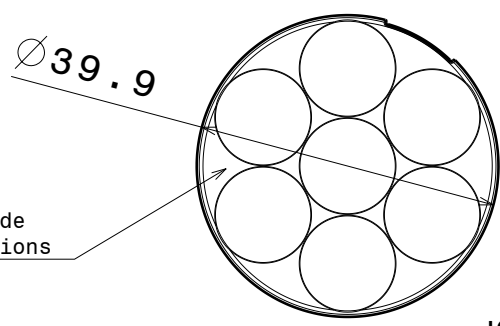

Same top side in all versions

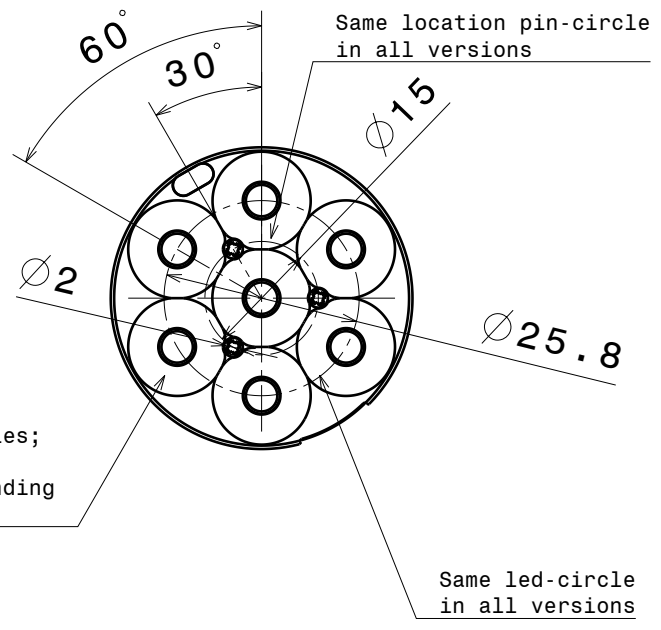
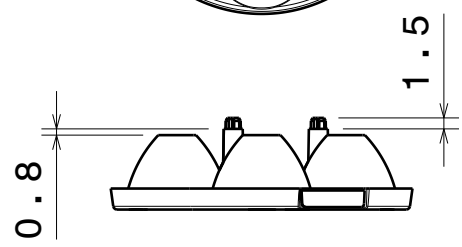

Number of cones varies; 3, 4, 5, 6 and 7pcs on bottom side depending the version.

Material: PMMA

Versions:

- Anna-3-S
- Anna-3-M
- Anna-3-W
- Anna-4-S
- Anna-4-M
- Anna-4-W
- Anna-5-S
- Anna-5-M
- Anna-5-W
- Anna-6-S
- Anna-6-M
- Anna-6-W
- Anna-7-S
- Anna-7-M
- Anna-7-M2
- Anna-7-W

This drawing is our property. It can't be reproduced or communicated without our written agreement.



Ledil Oy  
Salorankau 10  
FIN-24100 SALO  
Finland

DRAWING TITLE

Datasheet Anna40-series Lens

DRAWN BY  
ah

DATE  
8.12.2011

CHECKED BY  
pv

DATE  
8.12.2011

SIZE  
A4

DRAWING NUMBER  
Anna-40

REV  
4

DESIGNED BY  
hh

DATE  
30.07.2010

SCALE 1:1

WEIGHT (g)

SHEET

1/1

D

A

4

4

3

3

2

2

1

1

Luminaire: LEDil Oy C11715\_ANNA-40-5-W\_(DURIS\_S5) Efficiency=88%  
Lamps: 1 x Osram DURIS S5 (GW PSLPS1.EC) 355lm @ 100mA CCT=6300K P=3.1W I=100mA

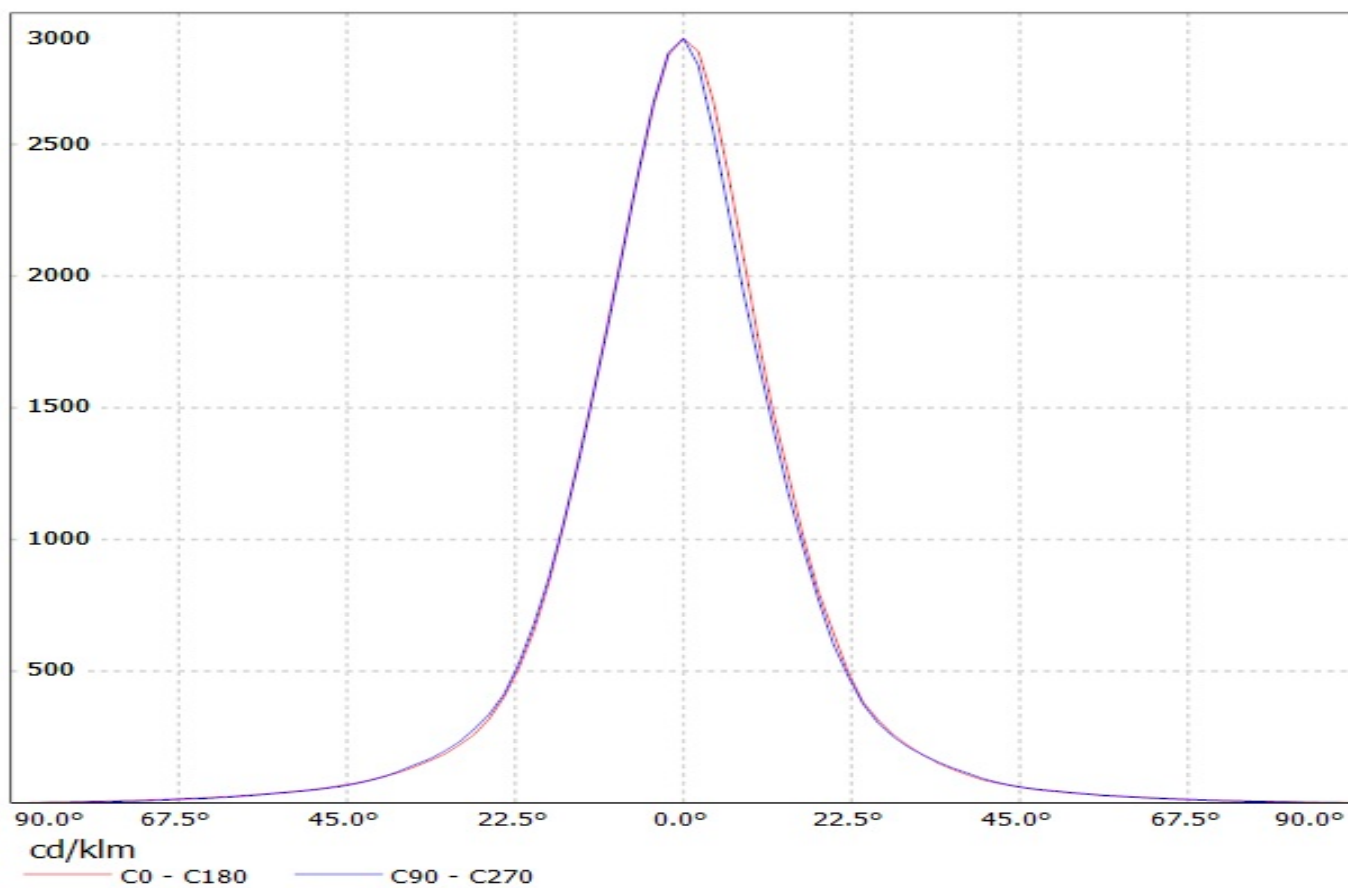

Luminaire: LEDil Oy C11715\_ANNA-40-5-W\_(DURIS\_S5) Efficiency=88%

Lamps: 1 x Osram DURIS S5 (GW PSLPS1.EC) 355lm @ 100mA CCT=6300K P=3.1W I=100mA

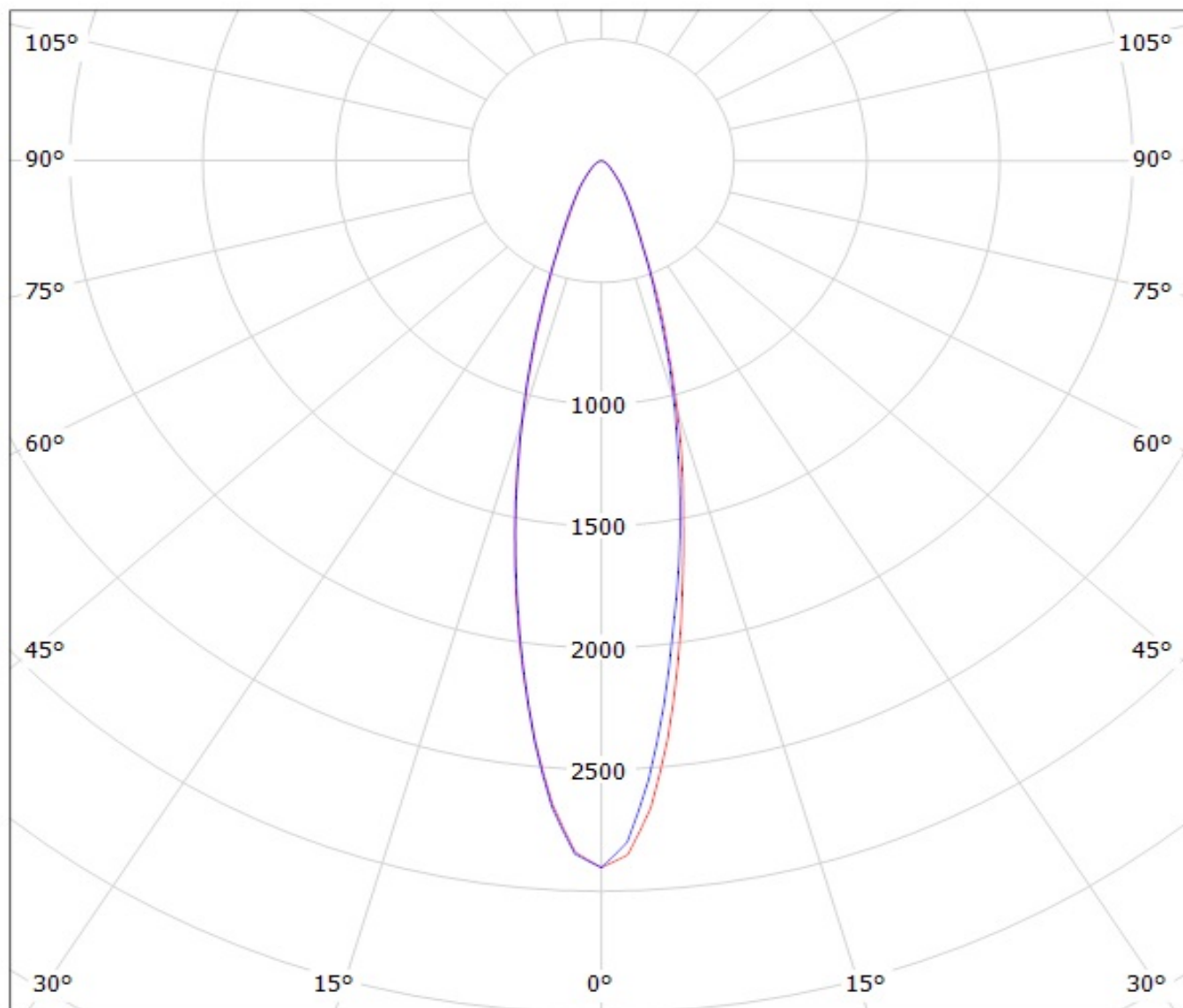

cd/klm

— C0 - C180

— C90 - C270

**NOTE: The typical divergence will be changed by different color, chip size and chip position tolerance. The typical total divergence is the full angle measured where the luminous intensity is half of the peak value.**